

Timberlane  
2/27/13

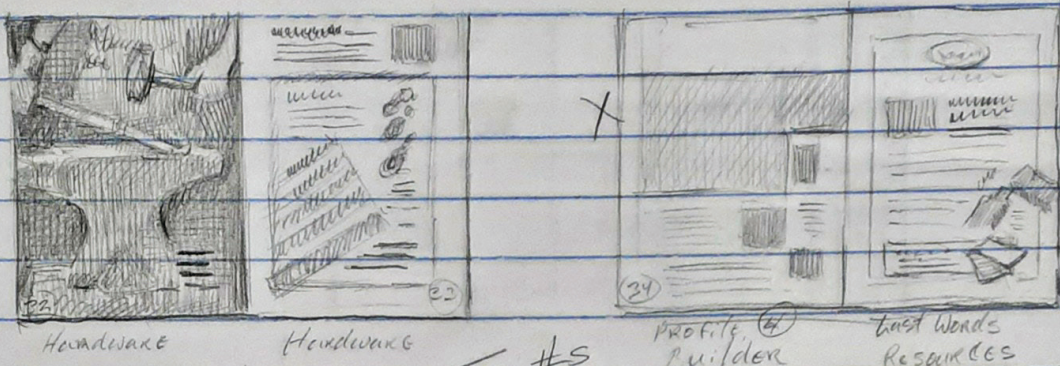

Hardware

Hardware

Profile Builder

Last Words Resources

Notes  
could be  
dark crafts  
new images

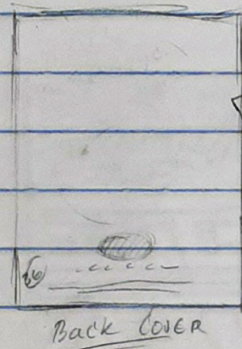

Back Cover

Effects for #5  
Bevel + Emboss  
Bevel / size: .125  
Soften: 0.625  
Depth: 100%  
Inner Smooth  
Down  
Angle: 120° Alt: 30°  
Opacity 100%  
Colors  
R 0  
G 2  
B 0

Profile Options

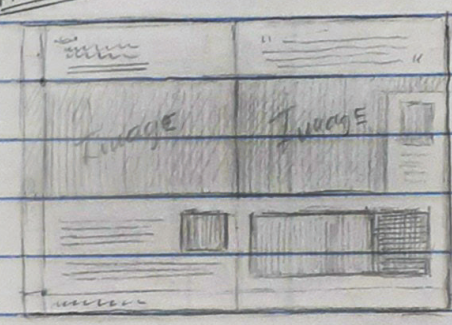

Technology options

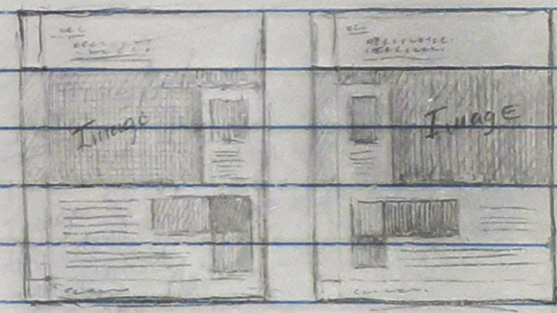
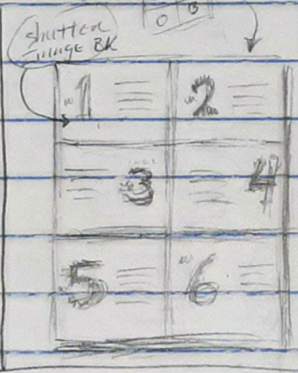
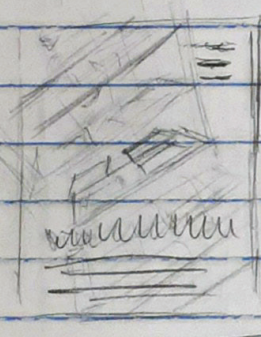

Intro pages options

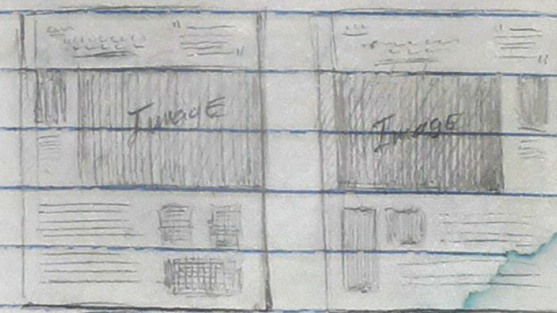
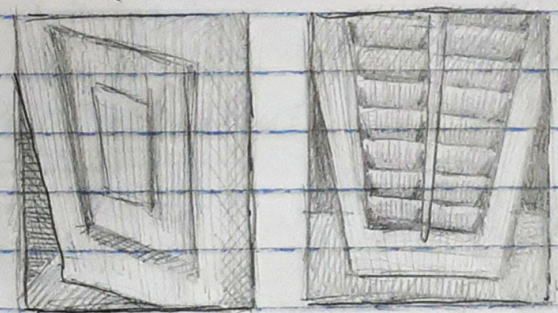

Note:  
Project bar

Note: Profile page could have a transitional color area at the bottom to separate information

Note:  
All  
Double up on Profiles  
make spreads Add four more pages

multicolored

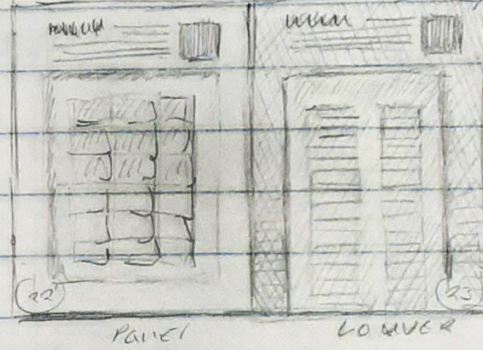
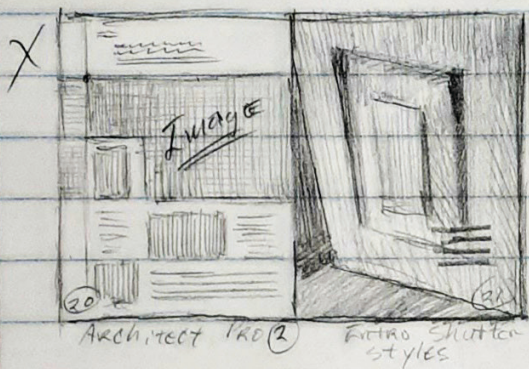
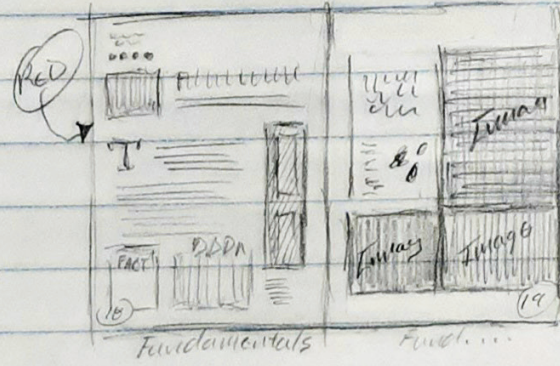
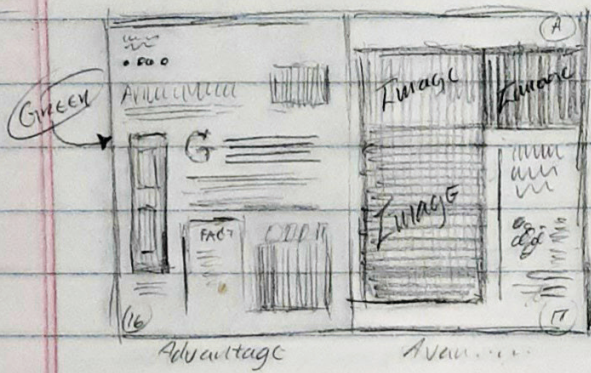

Note:  
back ground  
could  
go dark  
or have  
close fill  
  
Blue BK

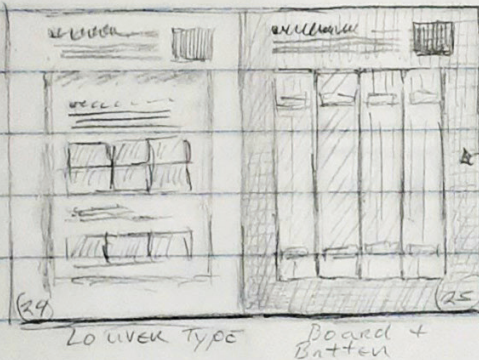

Olive BK  
0404  
14 Box  
2006-01  
-07-0002

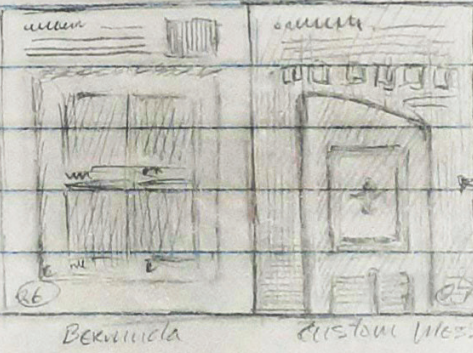

Green BK

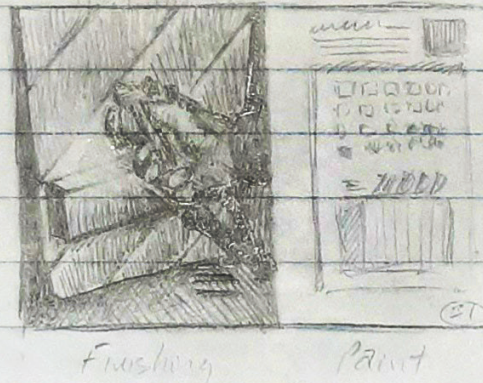
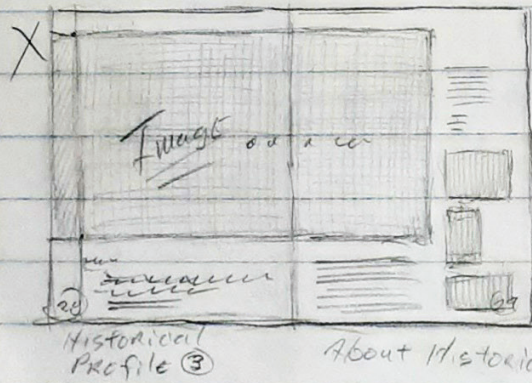

goals that  
you"

Endurian  
Quick Facts

Comparison  
chart

Timberland  
2/26/13

password for computer?  
ngdwttrs  
w3n1nordmz

T Brown  
Thursday 28

Notes  
Images

Idovan @ timberland  
Timberland &  
Master Image  
Folder  
Shutter Products  
shots

Colors Options

- Blue Endurian
- Olive Premium Wood
- Green Advantage
- Red Fundamental

cover 1

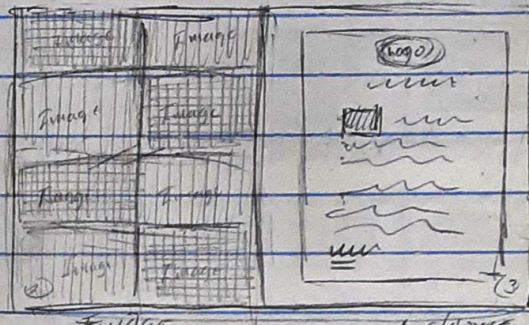
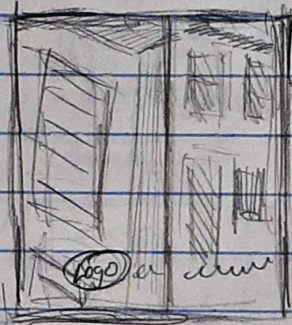

Notes  
could have the guide on this page

Notes  
there will be 6 steps

Process Colors

	Blue	Olive	Green
	36	55	37
	13	53	14
	21	73	45
	0	12	0
(60) Gray			
9	7		
16	14		
9	35		
9	60		
all	1/4	Wood	
0	33	39	
3	46	61	
1	47	80	
32	1	12	

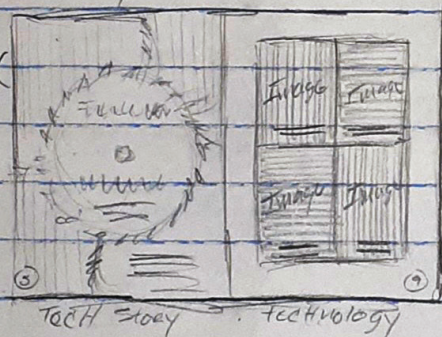
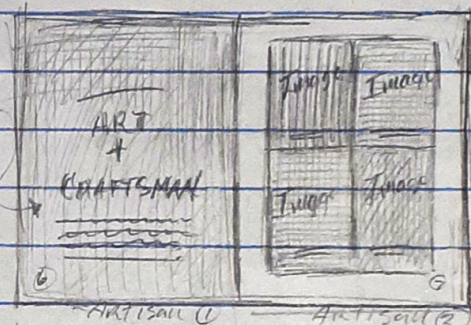
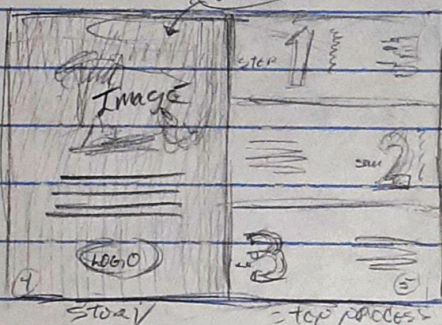

Notes  
- ENDURIAN  
- PREMIUM WOOD  
- ADVANTAGE  
- FUNDAMENTAL  
Step 1

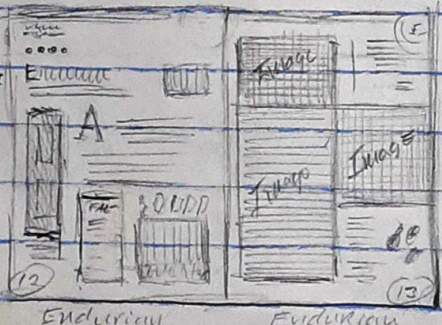

Blue

Olive

plane

Note: 3 1/2" x 11" Gate fold  
COVER Perfect Bound  
→ similar to flap-in on  
both sides

3 1/2  
12.5  
12.5  

---

37.5

148.00  

---

78.00

